



## Crimp Corbel Coupling

### AH Series

#### APPLICATION

Provides a high strength, offset coupling for polyethylene gas service pipes incorporating a coated steel, swan neck Body to enable the service pipe to pass over architectural features found in above ground installations.

#### DESCRIPTION

Comprising a double ended Crimp mechanical fitting for site assembly in either a powder coated or heavy duty Zinc coated finish for riser applications. A rubber Bush is supplied to support the GRP cover tube over the PE pipe.

Suitable for low and medium pressure installations.

#### CONSTRUCTION

- Body (1): Steel
- Insulation Washer (2): Engineering plastic
- Crimp Ring (4): Copper – annealed
- GRP Bush (5): EPDM Rubber
- GRP Shroud (if fitted): TPE Rubber
- Packing Tube (3): Cardboard
- Corrosion protection: Zinc electro plated

#### INSTALLATION

The Crimp joints should be made using the correct WASK Crimp tooling after the fitting has been inserted in to both pipes and correctly aligned.

#### SPECIFICATION

Meets GIS/PL3:2014 requirements, BSI Kite Mark certified KM587336.

Maximum Operating Pressure (MOP) = 5.5 Bar.



Every effort has been made to ensure that the information contained in this publication is accurate at the time of publishing. Crane Ltd assumes no responsibility or liability for typographical errors or omissions or for any misinterpretation of the information within the publication & reserves the right to change without notice.

**PE X PE SIZES**

Available in sizes from 20mm to 63mm.

**DIMENSIONS**

Dimension shown in mm.

SIZE = PE x PE DIAMETERS				
SIZE	D1	L1	L2	FINISH
20 SDR9	16	178	92	Zn8 + EP COATING
25 SDR11	25	182	92	Zn8 + EP COATING
32 SDR11	32	190	95	Zn8 + EP COATING
32 SDR11	32	SEE BELOW**		HD ZINC 125µm
63 SDR11	63			HD ZINC 125µm

\*\* Heavy Duty Zinc coated types are available with offsets (L2) in 10mm increments from 100mm to 250mm. Refer to factory for full details.

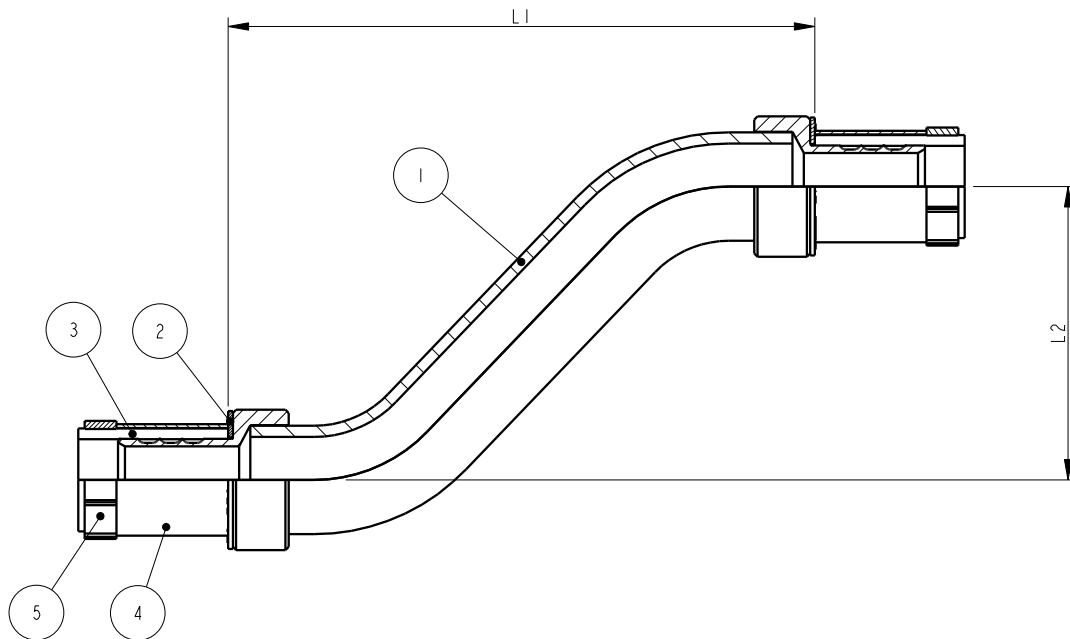

To visit our Video Library go to:  
[www.youtube.com/user/CraneBSU](http://www.youtube.com/user/CraneBSU)



46-48 WILBURY WAY, HITCHIN,  
 HERTFORDSHIRE, SG4 0UD  
 TELEPHONE: +44 (0)1462 443225  
 TELEPHONE: +44 (0)1462 443226  
 FAX: +44 (0)1462 443311  
 EMAIL: [sales@wask-uk.com](mailto:sales@wask-uk.com)  
[www.wask-uk.com](http://www.wask-uk.com)



FM 00311 EMS 553775

- Designed and manufactured under quality management systems in accordance with BS EN ISO 9001.

Every effort has been made to ensure that the information contained in this publication is accurate at the time of publishing. Crane Ltd assumes no responsibility or liability for typographical errors or omissions or for any misinterpretation of the information within the publication and reserves the right to change without notice.

W\_CCC\_1220\_V1