



# Crimp Corbel Meter Box Adaptor

## AJ Series

### APPLICATION

Provides a high strength transition fitting for a polyethylene gas service pipe to a Meter Box installed above ground that is above a brick corbel or step feature in the wall to enable a connection to the customer ECV and meter installation.

### DESCRIPTION

Comprising an extended Crimp mechanical fitting with an offset to the bulkhead connection to the Meter Box and terminating in a Male BSPT thread. The bulkhead connection features a Back Nut, Washer and Seal configuration. A rubber Bush is supplied to support the GRP cover tube over the PE pipe. Suitable for low and medium pressure gas meter installations.

### CONSTRUCTION

- Body (1): Steel
- Back Nut (7) & Washer (8): Steel
- Meter Box Seal (6): IIR Rubber
- Insulation Washer (2): Engineering plastic
- Crimp Ring (3): Copper – annealed
- GRP Bush (5): EPDM Rubber
- Packing Tube (4): Cardboard
- Protection Cap (9): PE
- Corrosion protection: Zinc plated & Epoxy/Polyester coated

### INSTALLATION

The Crimp joint should be made using the correct WASK Crimp before the fitting is installed in the Meter Box. The Back Nut, Washer and Seal are removed to allow the fitting to be installed in Inset or Recessed type boxes, then refitted and tightened to place to retain the fitting. For Surface mounted box the fitting can be slid in to place before tightening the Back Nut.



Every effort has been made to ensure that the information contained in this publication is accurate at the time of publishing. Crane Ltd assumes no responsibility or liability for typographical errors or omissions or for any misinterpretation of the information within the publication & reserves the right to change without notice.

**SPECIFICATION**

Meets GIS/PL3:2014 requirements, BSI Kite Mark certified KM587336.

Maximum Operating Pressure (MOP) = 5.5 Bar.

**PE X STEEL SIZES**

Available in sizes from 20mm to 32mm with threads 3/4" BSPT.

**DIMENSIONS**

Dimension shown in mm.

SIZE = PE x NOMINAL OUTLET THREAD DIAMETER						
SIZE	L1	L2	L3	L4	D1	D2
20 SDR9 x 3/4"	54	172	36	92	20	3/4" BSPT
25 SDR11 x 3/4"	54	172	36	92	25	3/4" BSPT
25 SDR11 x 3/4"	54	286	36	92	25	3/4" BSPT
32 SDR11 x 3/4"	54	172	38	92	32	3/4" BSPT
32 SDR11 x 3/4"	54	286	38	92	32	3/4" BSPT

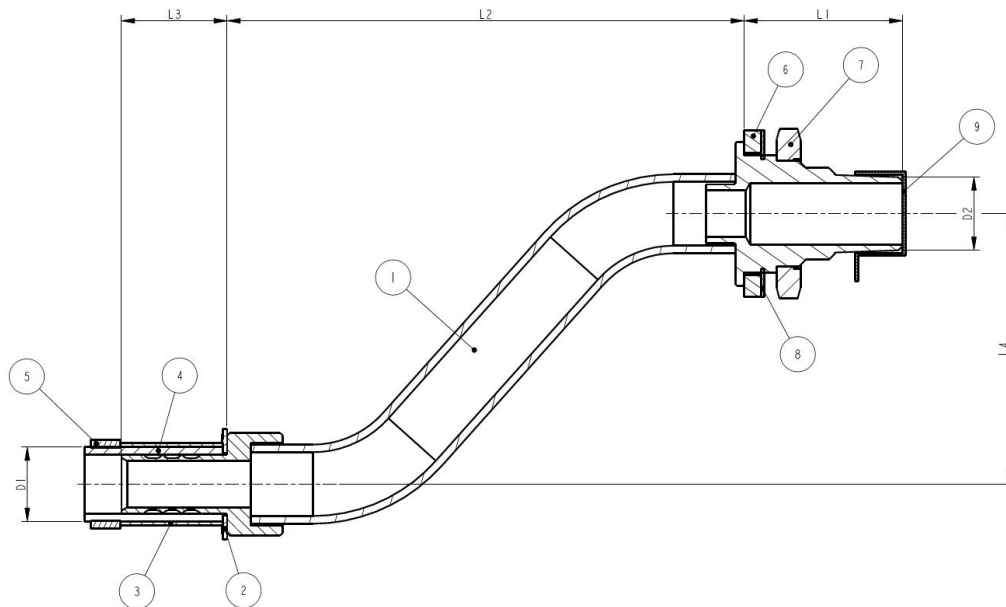

To visit our Video Library go to:  
[www.youtube.com/user/CraneBSU](http://www.youtube.com/user/CraneBSU)



46-48 WILBURY WAY, HITCHIN,  
 HERTFORDSHIRE, SG4 0UD  
 TELEPHONE: +44 (0)1462 443225  
 TELEPHONE: +44 (0)1462 443226  
 FAX: +44 (0)1462 443311  
 EMAIL: [sales@wask-uk.com](mailto:sales@wask-uk.com)  
[www.wask-uk.com](http://www.wask-uk.com)



FM 00311 EMS 553775

- Designed and manufactured under quality management systems in accordance with BS EN ISO 9001.

Every effort has been made to ensure that the information contained in this publication is accurate at the time of publishing. Crane Ltd assumes no responsibility or liability for typographical errors or omissions or for any misinterpretation of the information within the publication and reserves the right to change without notice.

W\_CCMB\_A\_0121\_V1