



Crimp Coupling

AH Series

APPLICATION

Provides a high strength, low profile coupling for polyethylene gas service pipes, can be used for emergency repair above or below ground and for service insertion inside existing steel services.

DESCRIPTION

Comprising a double ended Crimp mechanical fitting in either size on size or reducing diameter configurations. Heavy duty Zinc coating available for riser applications. For below ground applications fitting must be suitably protected.

Suitable for low and medium pressure installations.

CONSTRUCTION

- Body (1): Steel
- Insulation Washer (2): Engineering plastic
- Crimp Ring (4): Copper – annealed
- Packing Tube (3): Cardboard
- Corrosion protection: Zinc electro plated

INSTALLATION

The Crimp joints should be made using the correct WASK Crimp tool after the fitting has been inserted on to both pipes. Fittings installed below ground must have an approved site corrosion protection system applied after installation and pressure testing.

SPECIFICATION

Meets GIS/PL3:2014 requirements, BSI Kite Mark certified KM587336.

Maximum Operating Pressure (MOP) = 5.5 Bar.



Every effort has been made to ensure that the information contained in this publication is accurate at the time of publishing. Crane Ltd assumes no responsibility or liability for typographical errors or omissions or for any misinterpretation of the information within the publication & reserves the right to change without notice.

PE X PE SIZES

Available in sizes from 16mm to 32mm.

DIMENSIONS

Dimension shown in mm.

SIZE = PE x PE DIAMETERS				
SIZE	D1	D2	L1	FINISH
16 SDR7 x 20 SDR9	16	20	63	Zn8
20 SDR9 x 20 SDR9	20	20	74	Zn25
20 SDR9 x 25 SDR11	20	25	74	Zn8
20 SDR9 x 32 SDR11	20	32	75	Zn8
25 SDR11 x 25 SDR11	25	25	74	Zn25
25 SDR11 x 32 SDR11	32	32	75	Zn8
32 SDR11 x 32 SDR11	32	32	77	Zn25

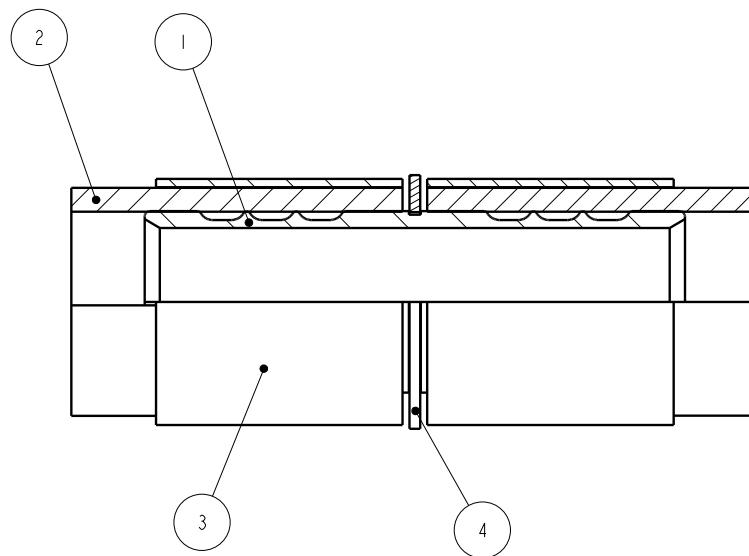

To visit our Video Library go to:
www.youtube.com/user/CraneBSU



46-48 WILBURY WAY, HITCHIN,
 HERTFORDSHIRE, SG4 0UD
 TELEPHONE: +44 (0)1462 443225
 TELEPHONE: +44 (0)1462 443226
 FAX: +44 (0)1462 443311
 EMAIL: sales@wask-uk.com
www.wask-uk.com



FM 00311 EMS 553775

- Designed and manufactured under quality management systems in accordance with BS EN ISO 9001.

Every effort has been made to ensure that the information contained in this publication is accurate at the time of publishing. Crane Ltd assumes no responsibility or liability for typographical errors or omissions or for any misinterpretation of the information within the publication and reserves the right to change without notice.

W_CC_1120_v1