



Crimp House Entry Tee

AF Series

APPLICATION

Provides a high strength transition fitting for polyethylene gas pipe to a building via a steel 90° elbow and steel through wall pipe for an above ground entry connection.

DESCRIPTION

Comprising a Crimp site made mechanical joint, an integral shut off stopper valve and a steel through wall outlet pipe with tight fit PE cover terminating with a corresponding BSPT thread. Suitable for low pressure gas services.

CONSTRUCTION

- Body (1) and Cap (8): Steel
- Wall Seal (10) & GRP Shroud (2): TPE Rubber
- Stopper & Cap Seals (12 & 13): NBR Rubber
- GRP Bush (6): EPDM Rubber
- Crimp Ring (5): Copper – annealed
- Insulation Washer (3) & Stopper (7): Engineering plastic
- Retention Washer (14): Spring Steel
- Weather Plug (9) & Wall Sleeve (11): PE
- Packing Tube (4): Cardboard
- Corrosion protection: Zinc plate & Polyester coating

INSTALLATION

Crimp House Entry Tees are supplied suitable for site installation with the internal Stopper Plug in the open position to facilitate testing. The correct size of core drill should be used for the through wall branch. The Crimp joint should be installed using the correct WASK Crimp tool and the internal Stopper Plug can be operated if required using the WASK tool BE0034.



Every effort has been made to ensure that the information contained in this publication is accurate at the time of publishing. Crane Ltd assumes no responsibility or liability for typographical errors or omissions or for any misinterpretation of the information within the publication & reserves the right to change without notice.

SPECIFICATION

Meets GIS/PL3:2014 requirements, BSI Kite Mark certified KM587336.
 Maximum Operating Pressure (MOP) = 2.0 Bar.

SIZE = PE x NOMINAL OUTLET THREAD DIAMETER						
SIZE	L1	L2	L3	D1	D2	CORE Ø
20 SDR9 x ¾"	25	See Below	45	20	¾" BSPT	35
25 SDR11 x ¾"	25		45	25	¾" BSPT	35
32 SDR11 x 1"	29		45	32	1" BSPT	45

Through wall branch lengths are available in the following standard sizes.

PE X STEEL SIZES

Available in sizes from 20mm to 32mm with threads ¾" BSPT or 1" BSPT. Various through wall lengths are available see table below.

D2	L2 LENGTHS									
¾"	150	200	250	295	345	500	610	750	910	1000
1"	150	-	-	295	345	500	610	750	910	1000

DIMENSIONS

Dimension shown in mm.

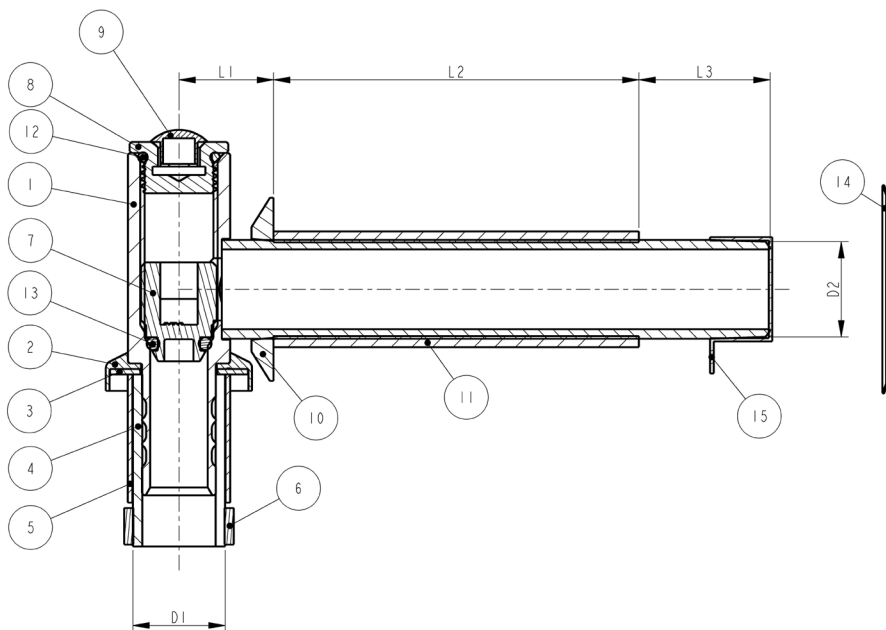

To visit our Video Library go to:
www.youtube.com/user/CraneBSU



46-48 WILBURY WAY, HITCHIN,
 HERTFORDSHIRE, SG4 0UD
 TELEPHONE: +44 (0)1462 443225
 TELEPHONE: +44 (0)1462 443226
 FAX: +44 (0)1462 443311
 EMAIL: sales@wask-uk.com
www.wask-uk.com



FM 00311 EMS 553775

- Designed and manufactured under quality management systems in accordance with BS EN ISO 9001.

Every effort has been made to ensure that the information contained in this publication is accurate at the time of publishing. Crane Ltd assumes no responsibility or liability for typographical errors or omissions or for any misinterpretation of the information within the publication and reserves the right to change without notice.

W_CHET_0121_V1