



# PECAT® 63mm Factory Entry Elbow

AG Series

## APPLICATION

Provides a high strength transition fitting for connecting polyethylene gas pipe to a building via a steel 90° elbow and through wall pipe for an above ground connection.

## DESCRIPTION

Comprising a PECAT® mechanical joint, factory assembled with straight length of PE pipe with a GRP protective cover sleeve, a through wall steel outlet with tight fit PE cover terminating with a corresponding BSPT thread.

## CONSTRUCTION

- Body (1): Steel
- Outlet pipe cover (7): PE
- Inlet pipe (5): PE to GIS/PL2-2
- PE Cover tube(3): GRP
- GRP Cover (2) Support (3) & Wall Seal (6): EPDM Rubber
- Corrosion protection: Zinc & Polyester coating.

## INSTALLATION

Factory Entry Elbows are supplied suitable for site jointing by electro fusion only. Adjustment to entry height can be made by cutting PE & GRP tubes on site, no adjustment to through wall length is possible, see table below for available options.

Please refer to the PE fitting manufacturer's instructions for details on electro fusion welding procedures.

## SPECIFICATION

Meets GIS/PL3:2014 requirements, BSI Kite Mark certified - KM535530.

Maximum Operating Pressure (MOP) = 2.0 Bar.



Every effort has been made to ensure that the information contained in this publication is accurate at the time of publishing. Crane Ltd assumes no responsibility or liability for typographical errors or omissions or for any misinterpretation of the information within the publication & reserves the right to change without notice.

**PE X OUTLET SIZES**

63mm SDR11 x 2" BSPT.

**DIMENSIONS**

**Note:** consult the factory for sizes not shown in table on the right. L1 lengths up to 4m are available.

SIZE = PE DIAMETER x OUTLET SIZE / TYPE				
SIZE	L1	L2	D1	OUTLET TYPE
63 x 2"	1000	150	2"	BSPT
63 x 2"	1000	345	2"	BSPT
63 x 2"	1000	500	2"	BSPT
63 x 2"	1000	610	2"	BSPT
63 x 2"	1000	750	2"	BSPT
63 x 2"	1000	1000	2"	BSPT
63 x 2"	1000	1100	2"	BSPT
63 x 2"	1000	1300	2"	BSPT

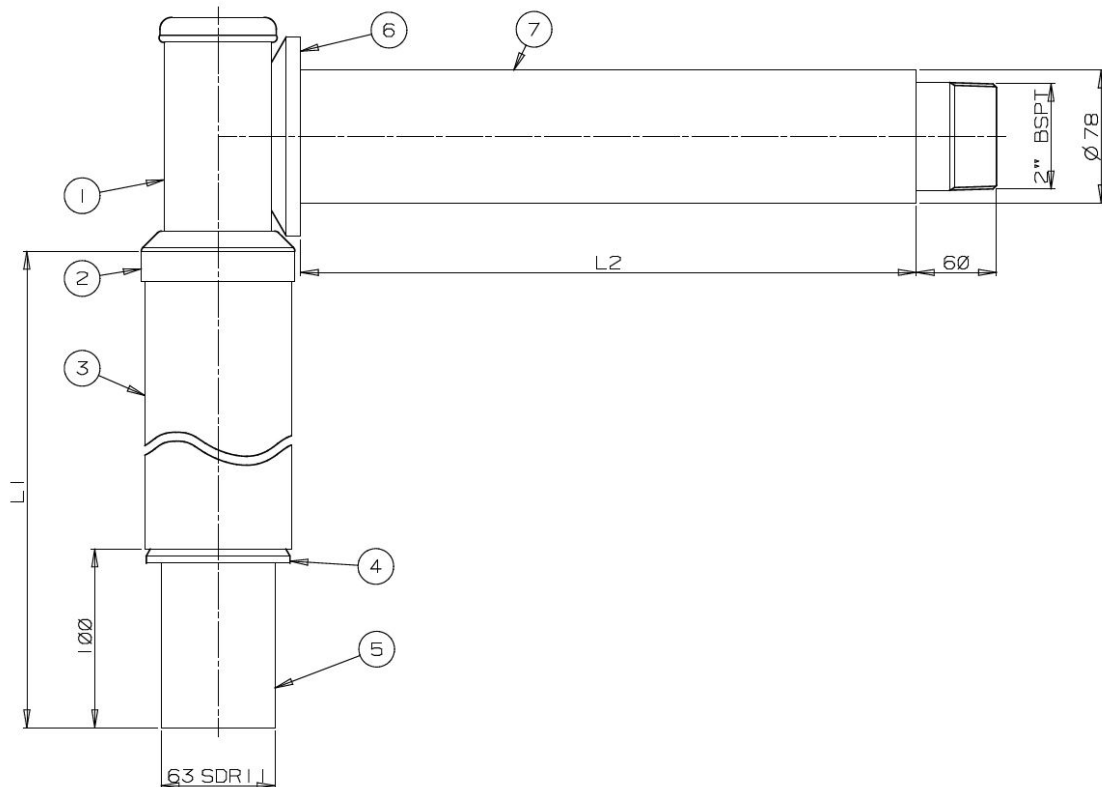

To visit our Video Library go to:  
[www.youtube.com/user/CraneBSU](http://www.youtube.com/user/CraneBSU)



46-48 WILBURY WAY, HITCHIN,  
 HERTFORDSHIRE, SG4 0UD  
 TELEPHONE: +44 (0)1462 443225  
 TELEPHONE: +44 (0)1462 443226  
 FAX: +44 (0)1462 443311  
 EMAIL: [sales@wask-uk.com](mailto:sales@wask-uk.com)  
[www.wask-uk.com](http://www.wask-uk.com)



FM 00311      EMS 553775

• Designed and manufactured under quality management systems in accordance with BS EN ISO 9001.

Every effort has been made to ensure that the information contained in this publication is accurate at the time of publishing. Crane Ltd assumes no responsibility or liability for typographical errors or omissions or for any misinterpretation of the information within the publication and reserves the right to change without notice.

W\_P63FEE\_1220\_V1