



PECAT® Garage Entry Bend

BY Series

APPLICATION

Provides a high strength, fire resistant building entry fitting for connecting a polyethylene gas service pipe to an internal metering or pressure reduction installation for below ground connection.

DESCRIPTION

Comprising a PECAT® mechanical joint, factory assembled with a length of PE pipe within a Steel protective sleeve, the sleeve is protected with a tight fit PE cover. The Sleeve is then bent through 90° to provide an outlet above ground.

Threaded outlets are available in Male or Female BSPT for connection to the ECV or internal pipe work.

CONSTRUCTION

- Body (1) and Sleeve (3): Steel
- Outlet pipe cover (4): PE
- Inlet pipe (2): PE to GIS/PL2-2
- Sleeve Seal (5): EPDM Rubber
- Corrosion protection: PE & Zinc plate

INSTALLATION

Garage Entry Bends are supplied suitable for site jointing by electro fusion only.

No adjustment to Body lengths are possible, see table below for available length options. The PE inlet pipe can be shortened on site if required.

Please refer to the PE fitting manufacturer's instructions for details on electro fusion welding procedures.



Every effort has been made to ensure that the information contained in this publication is accurate at the time of publishing. Crane Ltd assumes no responsibility or liability for typographical errors or omissions or for any misinterpretation of the information within the publication & reserves the right to change without notice.

SPECIFICATION

Meets GIS/PL3:2014 requirements, BSI Kite Mark certified - KM535530.
 Maximum Operating Pressure (MOP) = 2.0 Bar.

PE X OUTLET SIZES

25mm SDR11 x 3/4" to 63mm SDR11 x 2".

DIMENSIONS

Note: consult the factory for sizes not shown in table on the right.

SIZE = PE DIAMETER x OUTLET SIZE & TYPE							
SIZE	D1	D2	D3	L1	L2	L3	OUTLET TYPE
25 SDR11 x 3/4"	3/4" BSPT	25	33	500	500	450	MALE
25 SDR11 x 3/4"	3/4" BSPT	25	33	500	1000	450	MALE
25 SDR11 x 3/4"	3/4" BSPT	25	33	500	1000	450	FEMALE
32 SDR11 x 1"	1" BSPT	32	43	500	500	450	MALE
32 SDR11 x 1"	1" BSPT	32	43	500	1000	450	MALE
32 SDR11 x 1"	1" BSPT	32	43	1250	800	450	FEMALE
32 SDR11 x 1"	1" BSPT	32	43	1250	900	1000	FEMALE
63 SDR11 x 2"	2" BSPT	63	93	1250	800	450	FEMALE
63 SDR11 x 2"	2" BSPT	63	93	1250	800	1000	MALE

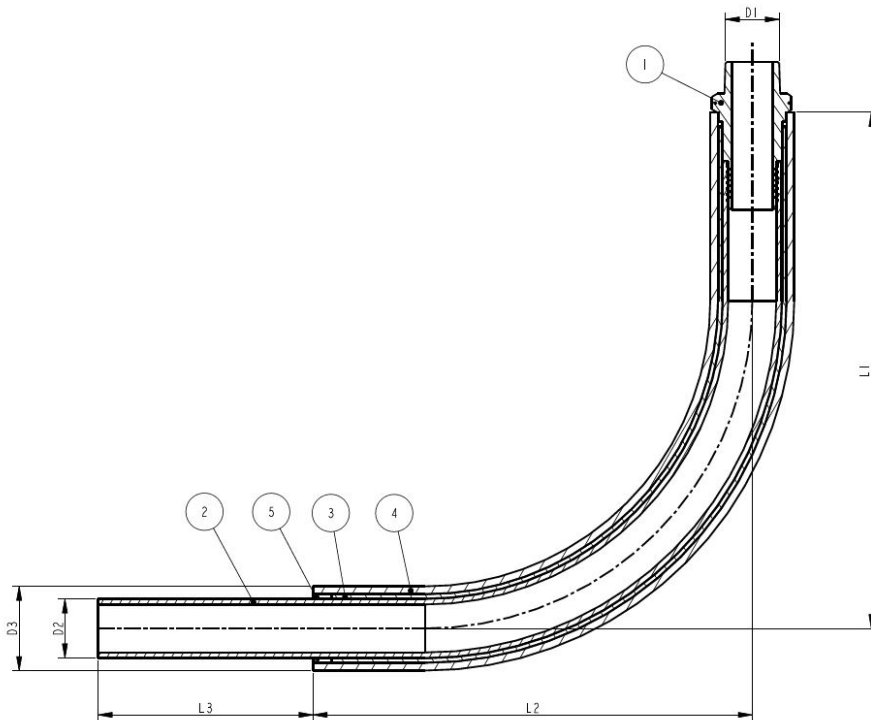

To visit our Video Library go to:
www.youtube.com/user/CraneBSU



46-48 WILBURY WAY, HITCHIN,
 HERTFORDSHIRE, SG4 0UD
 TELEPHONE: +44 (0)1462 443225
 TELEPHONE: +44 (0)1462 443226
 FAX: +44 (0)1462 443311
 EMAIL: sales@wask-uk.com
www.wask-uk.com



FM 00311 EMS 553775

- Designed and manufactured under quality management systems in accordance with BS EN ISO 9001.

Every effort has been made to ensure that the information contained in this publication is accurate at the time of publishing. Crane Ltd assumes no responsibility or liability for typographical errors or omissions or for any misinterpretation of the information within the publication and reserves the right to change without notice.

W_PGEB_1220_v1