



Service Head Adaptor

AZ Series

APPLICATION

Provides a fire resistant PE service termination connection to an existing steel gas service within a building which has been renewed by the insertion of a new PE service pipe.

DESCRIPTION

Two styles of fitting are available, comprising a Body connected to the steel inlet pipe by either a Female BSPT thread or a FlexGrip® compression joint, a second compression Olive joint within the body connects to the PE pipe and a third outlet thread joint connects to the ECV. The fitting has twin ports for grouting and venting during installation. Suitable for low and medium pressure gas mains.

CONSTRUCTION

- Body (1), Plugs (4) & Nut (10): Malleable Iron or SG Iron
- Outlet Nipple (2) & Insert Stiffener (5): Steel
- Gasket (7): NBR Rubber
- Grip Ring (8) & Washer (9): Steel
- Compression Olive (3): Brass
- Grouting Nipple (6): Engineering plastic
- Corrosion protection: Light oil film.

INSTALLATION

WASK Service Head Adaptor are supplied suitable for site installation using conventional spanners or pipe wrenches. The Body should be installed first followed by the PE compression joint which is made by tightening the outlet Nipple on to the Olive and once complete the ECV can be installed and pressure testing carried out. After passing pressure test the old pipe can be grouted and the side ports sealed with the plugs provided. Full instructions are supplied with each fitting.

FlexGrip® types should only be used below suspended floors or have adequate fire protection installed after assembly.



Female Type



Flexigrip Type

Every effort has been made to ensure that the information contained in this publication is accurate at the time of publishing. Crane Ltd assumes no responsibility or liability for typographical errors or omissions or for any misinterpretation of the information within the publication & reserves the right to change without notice.

SPECIFICATION

Meets GIS/PL3:2014 requirements, BSI Kite Mark certified – KM638820.
 Maximum Operating Pressure (MOP) = 2.0 Bar.

METALLIC PIPE SIZES

Available in sizes from 16mm to 32mm with female threads from 3/4" BSPT to 2" BSPT or FlexGrip® compression fittings from 1" to 2" nominal bore steel.
 Outlets are male BSPT 3/4" or 1".

SIZE = PE x OUTLET THREAD x INLET PIPE CONNECTION		
SIZE PE x BSP (Rs)	BSPT FEMALE	FLEXGRIP
20 SDR9 x 3/4"	1"	1"
20 SDR9 x 3/4"	1 1/4"	-
25 SDR11 x 3/4"	1 1/4"	1 1/4"
25 SDR11 x 3/4"	1 1/2"	-
32 SDR11 x 3/4"	1 1/2"	-
32 SDR11 x 1"	1 1/2"	1 1/2"
32 SDR11 x 1"	2"	2"

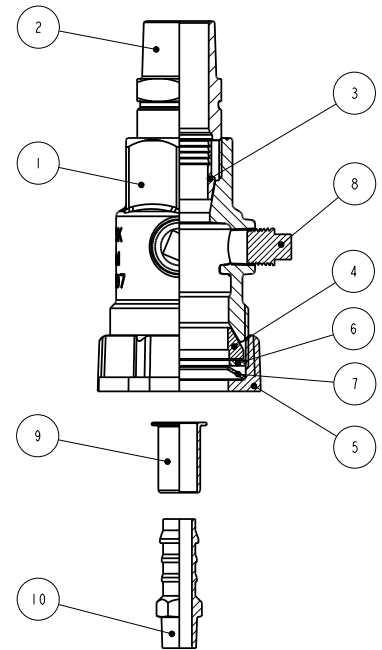
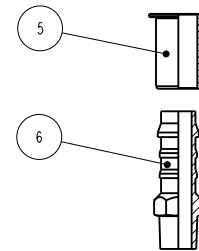
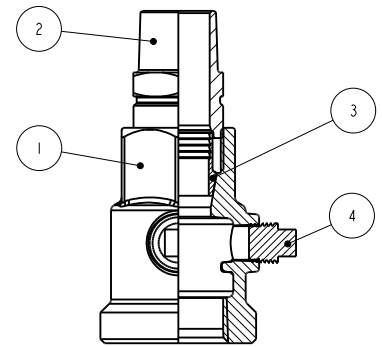

To visit our Video Library go to:
www.youtube.com/user/CraneBSU



46-48 WILBURY WAY, HITCHIN,
 HERTFORDSHIRE, SG4 0UD
 TELEPHONE: +44 (0)1462 443225
 TELEPHONE: +44 (0)1462 443226
 FAX: +44 (0)1462 443311
 EMAIL: sales@wask-uk.com
www.wask-uk.com



FM 00311 EMS 553775

• Designed and manufactured under quality management systems in accordance with BS EN ISO 9001.

Every effort has been made to ensure that the information contained in this publication is accurate at the time of publishing. Crane Ltd assumes no responsibility or liability for typographical errors or omissions or for any misinterpretation of the information within the publication and reserves the right to change without notice.

W_SHA_0121_v1