



Service Nipple

AR Series

APPLICATION

Provides a male threaded pipe connection to a metallic gas main which has been drilled and tapped with a parallel BSP thread. Usually used in conjunction with the upper part of a 2-part Top Service Tee, series AP or Donkin Series 455-1 Ball Valves.

DESCRIPTION

Comprising a threaded Nipple Body compatible with site tapped parallel threads to BS21 (Rp) specification, the fitting has an internal Stopper Plug to allow it to be installed under pressure. The fitting has a shaped Washer to compress the rubber Gasket to make a gas tight seal between the Nipple and surface of the main. The outlet is a 2" BSPT Male thread which can be joined to a valve or 2-Part Top Tee head works. Suitable for low and medium pressure gas mains.

CONSTRUCTION

- Nipple (1) Washer (2) & Back Nut (3): Malleable Iron or SG Iron
- Gasket (4) & Seals (6): NBR Rubber
- Stopper (5): Engineering plastic
- Corrosion protection: Light oil film – must be site protected.

INSTALLATION

Service Nipples are supplied suitable for installation using gas under pressure drilling machines conforming to GIS/E1 specification such as WASK Teeset® with a suitable fitting installation spindle. The EMID joint should be installed following the instructions for the alignment and tightening of the Back Nut included with the product. The internal Stopper Plug can be operated using the WASK tool EA0056 or EA0019 for Donkin Valves. Fittings must have an approved site corrosion protection system applied after installation and pressure testing.



Every effort has been made to ensure that the information contained in this publication is accurate at the time of publishing. Crane Ltd assumes no responsibility or liability for typographical errors or omissions or for any misinterpretation of the information within the publication & reserves the right to change without notice.

SPECIFICATION

Meets GIS/F2:2013 requirements, BSI Kite Mark certified – KM611750.

Maximum Operating Pressure (MOP) = 2.0 Bar.

METALLIC PIPE SIZES

Available with 2" BSPT male outlet thread and inlet threads in 1" BSP to 2" BSP, with special parallel BS21:1985 (Rs) thread form for use on gas mains up to 42" nominal diameter.

DIMENSIONS

May also be used on steel mains with thin walls (less than 3 thread pitches = 7mm) or non-metallic gas mains using a suitable WASK Pressure Drilling Saddle, see the AA Series range for details.

SIZE = OUTLET x INLET THREAD SIZES			
SIZE	D BSP (Rs)	L	MAIN MIN Ø
2" x 1"	1"	101	4"
** 2" x 1 ¼"	1 ¼"	109	5"
2" x 1 ½"	1 ½"	109	6"
2" x 2"	2"	109	8"

** This item to special order, please consult factory.

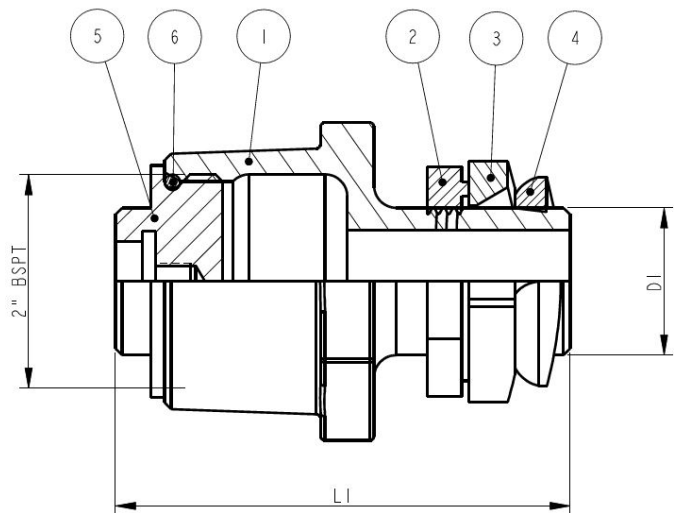

To visit our Video Library go to:
www.youtube.com/user/CraneBSU



46-48 WILBURY WAY, HITCHIN,
 HERTFORDSHIRE, SG4 0UD
 TELEPHONE: +44 (0)1462 443225
 TELEPHONE: +44 (0)1462 443226
 FAX: +44 (0)1462 443311
 EMAIL: sales@wask-uk.com
www.wask-uk.com



FM 00311 EMS 553775

- Designed and manufactured under quality management systems in accordance with BS EN ISO 9001.

Every effort has been made to ensure that the information contained in this publication is accurate at the time of publishing. Crane Ltd assumes no responsibility or liability for typographical errors or omissions or for any misinterpretation of the information within the publication and reserves the right to change without notice.

W_SN_0121_v1