

## FLEXIBLE TYPE

PART	SIZE
AZ0005C	20mm x 1 1/2" Steel Flexgrip x 3/4" BSPT
AZ0007C	25mm x 1 1/4" Steel Flexgrip x 3/4" BSPT
AZ0016C	32mm x 1 1/2" Steel Flexgrip x 1" BSPT
AZ0017C	32mm x 2" Steel Flexgrip x 1" BSPT

## MATERIALS

PART	MATERIALS
1. Flexigrip Endload Washer	Steel, Zinc plated
2. Flexigrip Steel Rubber Seal	Nitrile Rubber
3. Hose Tail	Polypropylene
4. Insert	Steel, Zinc plated
5. Nut	Cast Iron
6. SHA Body Machining	Cast Iron
7. SHA Olive	Brass
8. Slotted Endload Washer	High Tensile Steel, zinc plated
9. Steel Flexigrip Nut	Cast Iron
10. Taper Plug	Steel or Cast Iron



EXPLODED VIEW

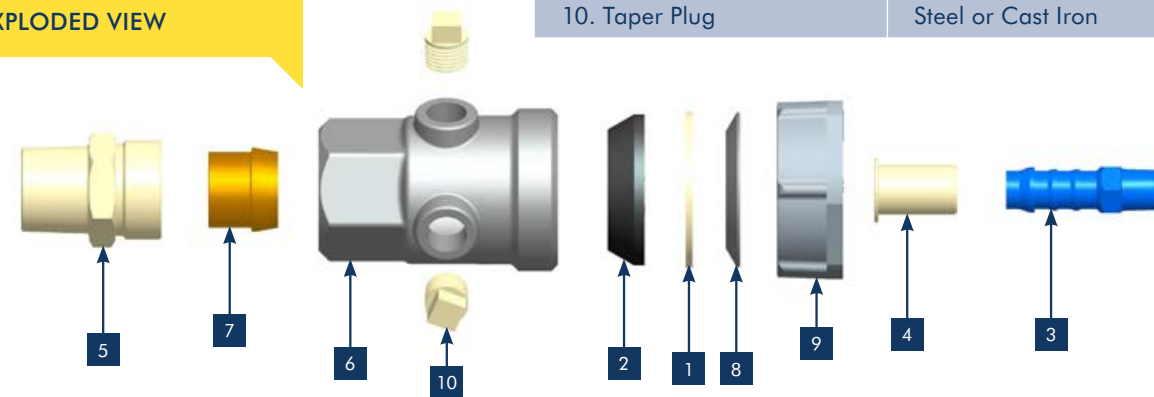

46-48 WILBURY WAY, HITCHIN,  
HERTFORDSHIRE, SG4 0UD  
TELEPHONE: +44 (0)1462 443226  
TELEPHONE: +44 (0)1462 443227  
FAX: +44 (0)1462 443311  
EMAIL: sales@wask-uk.com  
[www.wask-uk.com](http://www.wask-uk.com)



ISO 14001 Reg No. EMS 78657



To visit our Video Library go to:  
[www.youtube.com/user/CraneBSU](http://www.youtube.com/user/CraneBSU)

- Designed & manufactured under quality management systems in accordance with BS EN ISO 9001:2008

Every effort has been made to ensure that the information contained in this publication is accurate at the time of publishing. Crane Ltd assumes no responsibility or liability for typographical errors or omissions or for any misinterpretation of the information within the publication & reserves the right to change without notice.

W\_GSHA\_1016

# GAS SERVICE HEAD ADAPTOR

## THREADED & FLEXIBLE TYPES



FROM MAINS TO METER

FROM MAINS TO METER



# GAS SERVICE HEAD ADAPTOR

This fitting is used where a PE service pipe enters a building below ground.

It provides a site-assembled, concentric termination for the PE pipe and its steel carrier pipe to which the internal steel riser is connected. Two vent plugs are included in the body to permit the insertion of grout into the annular space between the PE pipe and the steel carrier.

The WASK Service Head Adapter is designed, constructed and tested fully in accordance with clause 6.2.5. of GIS/PL3. The use of such a fitting is recommended in IGEM publications IGE/TD/4: PE and steel gas services and service pipework & IGE/G/5: Gas in flats and other multi-occupancy buildings.

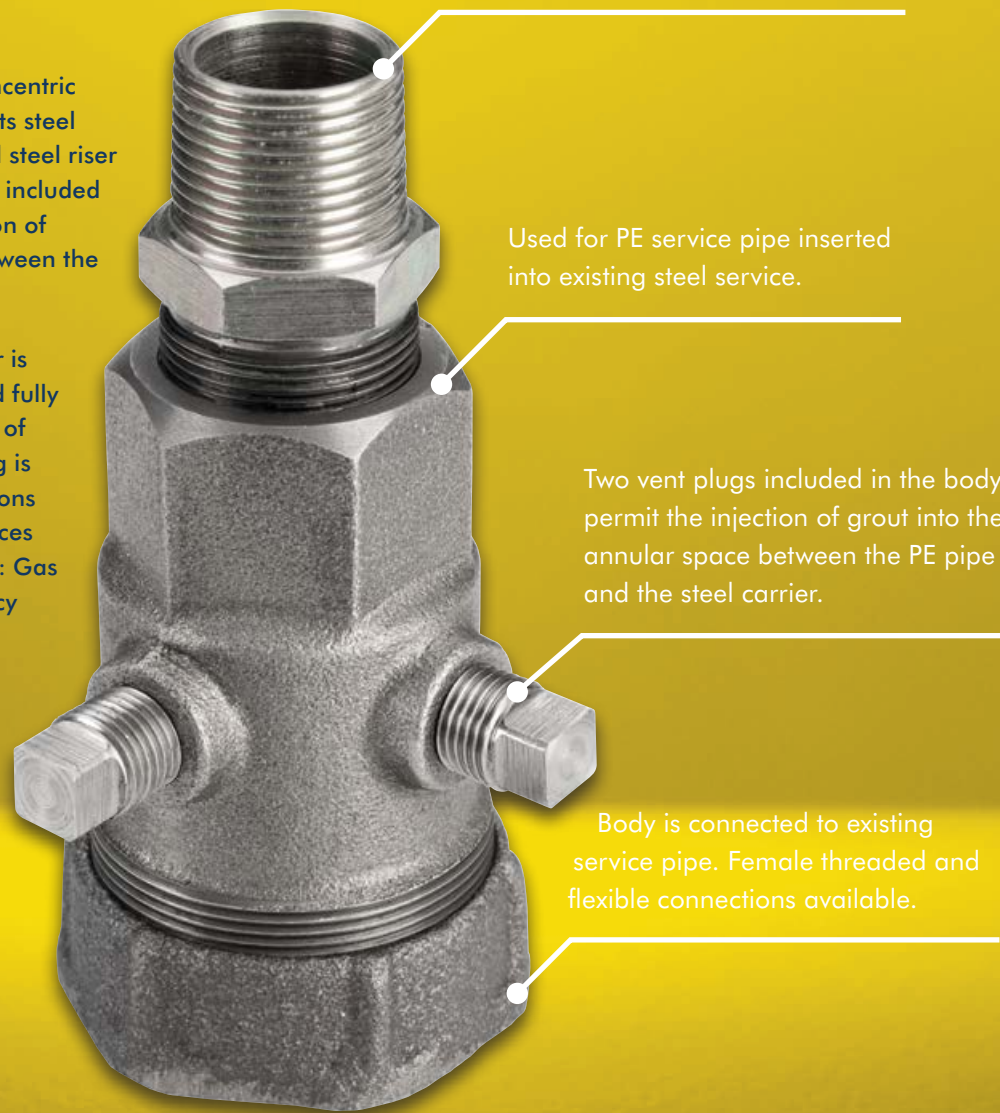

Provided a site-assembled, fire resistant termination for the PE service pipe.

Used for PE service pipe inserted into existing steel service.

Two vent plugs included in the body permit the injection of grout into the annular space between the PE pipe and the steel carrier.

Body is connected to existing service pipe. Female threaded and flexible connections available.

## CUSTOMER BENEFITS

- Fast and easy installation
- No special tools or costly installation equipment
- Can be assembled in confined spaces
- Minimal stress on PE piping
- Cost reduction due to a minimum number of joints
- PE Joint compliant with GIS/PL3 KM638820
- Flexigrip joint complies with GIS/PL3 KM595392
- Female threaded joint to BS EN10226-2
- Installation as per T/SP/SL1

# FEMALE THREADED SERVICE HEAD ADAPTOR

## FEMALE TYPE

PART	SIZE
AZ0002	16mm x 3/4" BSPT Female 3/4"
AZ0004	16mm x 3/4" BSPT Female 1"
AZ0006C	20mm x 1" BSPT Female x 3/4"
AZ0008C	25mm x 1 1/4" BSPT Female x 3/4"
AZ0009C	32mm x 1 1/2" BSPT Female x 3/4"
AZ0010C	32mm x 1 1/2" BSPT Female x 1"
AZ0013C	32mm x 2" BSPT Female x 1"
AZ0014C	25mm x 1 1/2" BSPT Female x 3/4"
AZ00015C	20mm x 1 1/4" BSPT Female x 3/4"



## MATERIALS

PART	MATERIALS
1. Hose Tail	Polypropylene
2. Insert	Steel, Zinc plated
3. Nut	Steel, Zinc plated
4. SHA Body Machining	Cast Iron
5. SHA Olive	Brass
6. Taper Plug	Steel or Cast Iron

