



PECAT® 63mm Building Entry Tee

AK Series

APPLICATION

Provides a high strength transition fitting for connecting polyethylene gas pipe to a building via a steel 90° elbow and through wall pipe for an above ground connection.

DESCRIPTION

Comprising a PECAT® mechanical joint, factory assembled with straight length of PE pipe with a GRP protective cover sleeve, a shut off stopper valve and a through wall steel outlet with tight fit PE cover terminating with a corresponding BSPT thread or plain ended tube for welding.

CONSTRUCTION

- Body (1), Sleeve, Cap (8) & Stopper (9): Steel
- Outlet pipe cover (7): PE
- Inlet pipe (5): PE to GIS/PL2-2
- PE Cover tube (3): GRP
- GRP Cover (2) Support (3) & Wall Seal (6): EPDM Rubber
- O-Ring (10): NBR Rubber
- Corrosion protection: Zinc & Polyester coating.

INSTALLATION

Building Entry Tees are supplied suitable for site jointing by electro fusion only. Adjustment to entry height can be made by cutting PE & GRP tubes on site, no adjustment to through wall length is possible, see table below for available options. Operation of the Stopper can be made using WASK tool, part code BE0128.

Please refer to the PE fitting manufacturer's instructions for details on electro fusion welding procedures.



Every effort has been made to ensure that the information contained in this publication is accurate at the time of publishing. Crane Ltd assumes no responsibility or liability for typographical errors or omissions or for any misinterpretation of the information within the publication & reserves the right to change without notice.

SPECIFICATION

Meets GIS/PL3:2014 requirements, BSI Kite Mark certified - KM535530.

Maximum Operating Pressure (MOP) = 2.0 Bar.

PE X OUTLET SIZES

63mm SDR11 x 2" (DN50), threaded BSPT or plain for welding.

DIMENSIONS

Note: consult the factory for sizes not shown in table on the right.
L1 lengths up to 4m are available.

SIZE = PE DIAMETER x OUTLET SIZE / TYPE				
SIZE	L1	L2	D1	OUTLET TYPE
63 x 2"	1000	150	2"	BSPT
63 x 2"	1000	345	2"	BSPT
63 x 2"	1000	500	2"	BSPT
63 x 2"	1000	610	2"	BSPT
63 x 2"	1000	1000	2"	BSPT
63 x 2"	1000	550	Ø60.3	PLAIN
63 x 2"	1000	610	Ø60.3	PLAIN
63 x 2"	1000	1100	Ø60.3	PLAIN
63 x 2"	1000	1300	Ø60.3	PLAIN

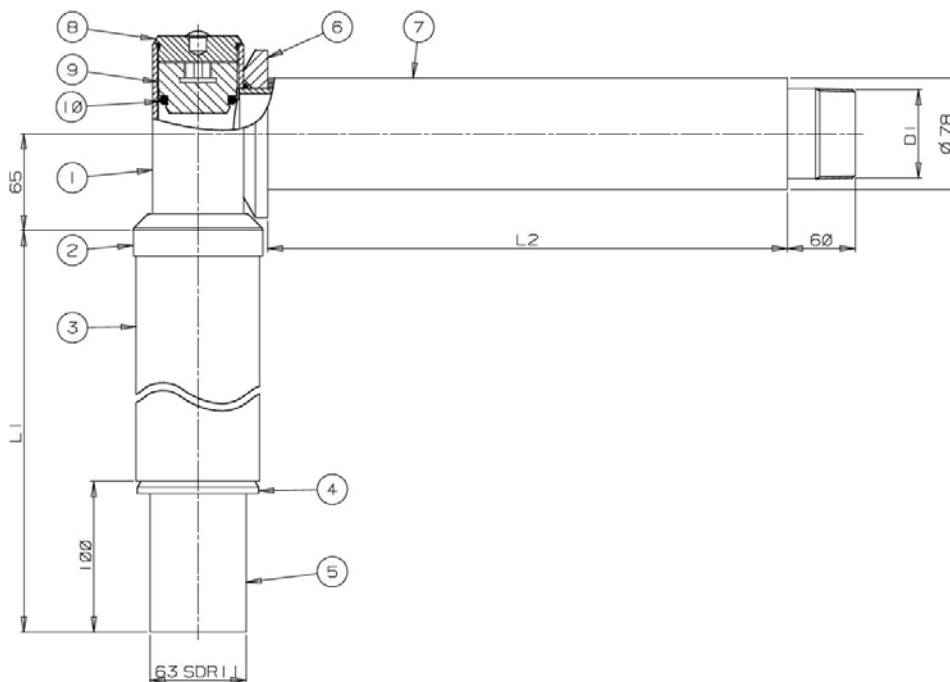

To visit our Video Library go to:
www.youtube.com/user/CraneBSU



46-48 WILBURY WAY, HITCHIN,
HERTFORDSHIRE, SG4 0UD
TELEPHONE: +44 (0)1462 443225
TELEPHONE: +44 (0)1462 443226
FAX: +44 (0)1462 443311
EMAIL: sales@wask-uk.com

www.wask-uk.com



FM 00311

EMS 553775

• Designed and manufactured under quality management systems in accordance with BS EN ISO 9001.

Every effort has been made to ensure that the information contained in this publication is accurate at the time of publishing. Crane Ltd assumes no responsibility or liability for typographical errors or omissions or for any misinterpretation of the information within the publication and reserves the right to change without notice.

W_P63BET_1220_v1