

PECAT[®] FACTORY ENTRY ELBOW SPLIT FLANGE

AG SERIES

APPLICATION

Provides a high strength transition fitting for connecting polyethylene gas pipe to a building via a steel 90° elbow and through wall pipe for an above ground connection.

DESCRIPTION

Comprising a PECAT[®] mechanical joint, factory assembled with straight length of PE pipe with a GRP protective cover sleeve, a through wall steel outlet with tight fit PE cover terminating with a corresponding NP16 Split Flange assembly.

FEATURES & BENEFITS

- Innovative split flange design, ensures no need for welder on site - result - cost & time savings
- Smallest through wall drilling diameters for split flange design
- No need for additional "bungs" to be fitted to stabilise fitting in wall cavity
- Neat & clean external look once fitting is complete
- Kitemark approved to GIS/PL3 (KM 535530)
- Factory fitted PE tails & GRP cover, available in 1m, 1.5m & 2m lengths
- Maintenance free

CONSTRUCTION

- Body (1), Sleeve (2) & Retainer (9): Steel
- Outlet pipe cover (6): PE
- Inlet pipe (4): PE to GIS/PL2-2
- Flange (8) & Bracket (7): SG Iron
- PE Cover tube (5): GRP
- O-Ring (10): NBR rubber
- Cover tube support (3): EPDM Rubber
- Corrosion protection: Zinc plate & Epoxy/Polyester coating



FROM MAINS TO METER

PECAT® FACTORY ENTRY ELBOW SPLIT FLANGE

SPECIFICATION

Meets GIS/PL3:2014 requirements,
BSI Kite Mark certified - KM535530.

Maximum Operating Pressure (MOP)
= 2.0 Bar.

PE X OUTLET SIZES

90mm SDR11 x 80 NP16 to
180mm SDR17.6 x 150 NP16

DIMENSIONS

Dimensions in mm.

Note: consult the factory for sizes not
shown in table below.

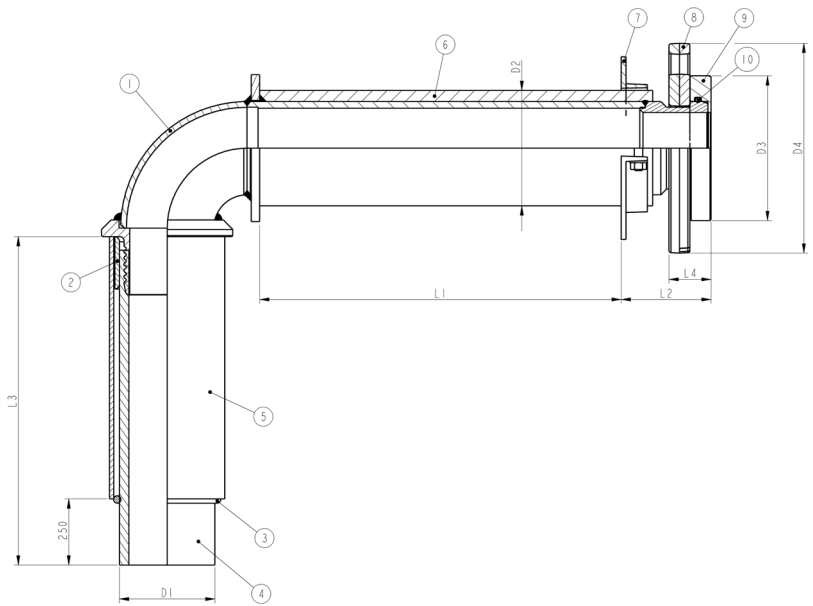

SIZE = PE DIAMETER x OUTLET FLANGE SIZE (NP16)

PART NO.	SIZE	D1	D2	Ø CORE HOLE (MIN)	D3	D4	L1	L2	L3	L4
AG2110	90/17.6 x 80	90	112	115	130	200	345	88	1000	40
AG2111	90/17.6 x 80	90	112	115	130	200	345	88	2000	40
AG2112	90/17.6 x 80	90	112	115	130	200	500	88	1000	40
AG2118	90/17.6 x 80	90	112	115	130	200	500	88	2000	40
AG2119	90/17.6 x 80	90	112	115	130	200	610	88	1000	40
AG2120	90/17.6 x 80	90	112	115	130	200	610	88	2000	40
AG2121	125/17.6 x 100	125	143	145	158	220	345	91	1000	42
AG2122	125/17.6 x 100	125	143	145	158	220	345	91	2000	42
AG2123	125/17.6 x 100	125	143	145	158	220	610	91	1000	42
AG2124	125/17.6 x 100	125	143	145	158	220	610	91	2000	42
AG2127	180/17.6 x 150	180	205	210	212	285	345	106	1000	44
AG2128	180/17.6 x 150	180	205	210	212	285	345	106	2000	44
AG2129	180/17.6 x 150	180	205	210	212	285	610	106	1000	44
AG2130	180/17.6 x 150	180	205	210	212	285	610	106	2000	44



To visit our Video Library go to:
www.youtube.com/user/CraneBSU



46-48 WILBURY WAY, HITCHIN,
HERTFORDSHIRE, SG4 0UD
TELEPHONE: +44 (0)1462 443225
TELEPHONE: +44 (0)1462 443226
FAX: +44 (0)1462 443311
EMAIL: sales@wask-uk.com

www.wask-uk.com



FM 00311 EMS 553775

- Designed and manufactured under quality management systems in accordance with BS EN ISO 9001.

Every effort has been made to ensure that the information contained in this publication is accurate at the time of publishing. Crane Ltd assumes no responsibility or liability for typographical errors or omissions or for any misinterpretation of the information within the publication and reserves the right to change without notice.

W_PFEFF_0121_v1